

# Rotorflush RF200 Range Self-cleaning Filter

## General Specifications

### General Arrangements



*Above shows RF200AS Fitted with  
315 micron Sintered Stainless Steel  
Mesh*



*Above shows RF200A Fitted  
with 300 micron Nylon Mesh*

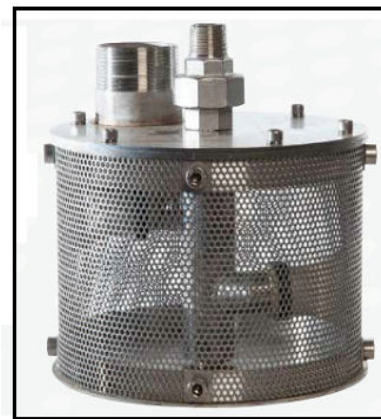

*Above shows RF200R Fitted with  
3mm Perforated Stainless Steel  
Mesh*

### Key Features

- Filtration between 50 microns and 6mm
- Self-cleaning with minimal maintenance
- Stainless Steel construction
- High reliability and easy to use
- 220 litres per minute maximum flow
- Reduced capital, installation and maintenance costs
- Continuous backwash keeps filter mesh clear
- Protects pumps and other equipment
- 316 Stainless Steel option also available

# Rotorflush RF200 Range Self-cleaning Filter

## General Specifications

### Models and Specifications

Model	Max pump output (m3/h)	Mesh Type	Mesh Size Options	Backwash Volume Required (m3/h)
RF200A	14	Nylon	60, 115, 300 micron	2.5-3.5
RF200AS	14	316 Stainless Steel	50, 100, 315 micron sintered	2.5-3.5
RF200AR	14	316 Stainless Steel	1mm, 2mm, 3mm woven	2.5-3.5
RF200R	14	316 Stainless Steel	3mm or 6mm Perforated	1.5-3.5

\*These models are available with US NPT Fittings

### Dimensions and Weights

Model	Height (mm)	Filter Diameter (mm)	Filter Height	Weight (kg)	Pump Outlet	Backwash Outlet
RF200A	206	210	145	4	2" BSP	¾" BSP
RF200AS	206	210	145	5	2" BSP	¾" BSP
RF200AR	206	210	145	5	2" BSP	¾" BSP
RF200R	206	210	145	5	2" BSP	¾" BSP

\*Dimensions and weights are approximate

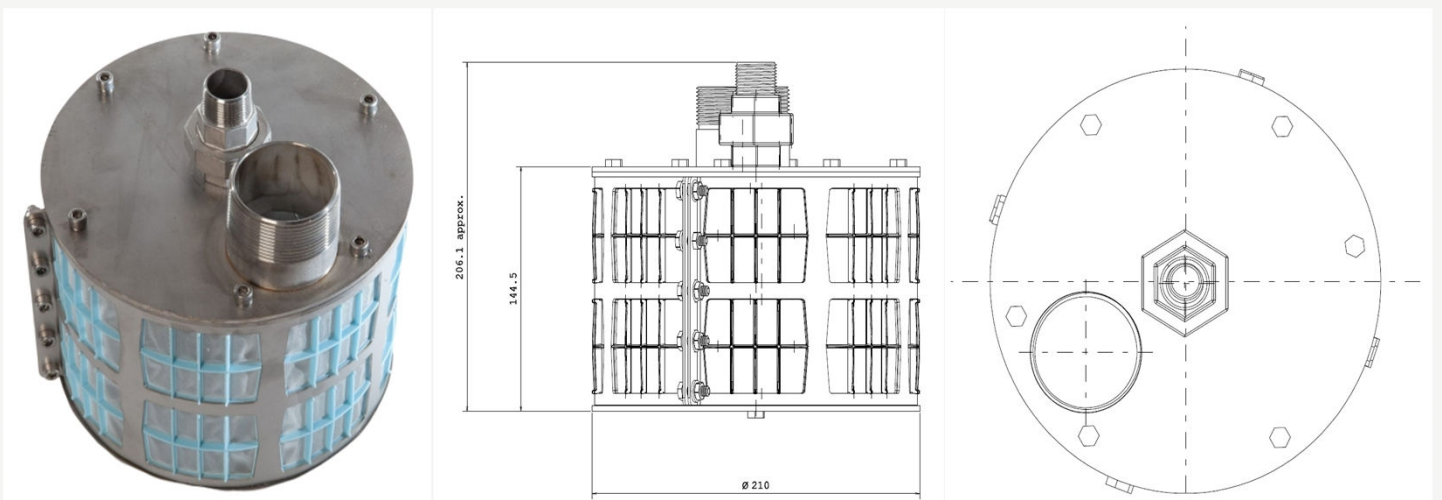

RF200A

# Rotorflush RF200 Range Self-cleaning Filter

## General Specifications

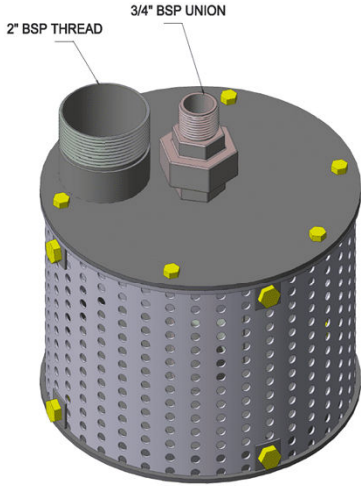

RF200R Perforated

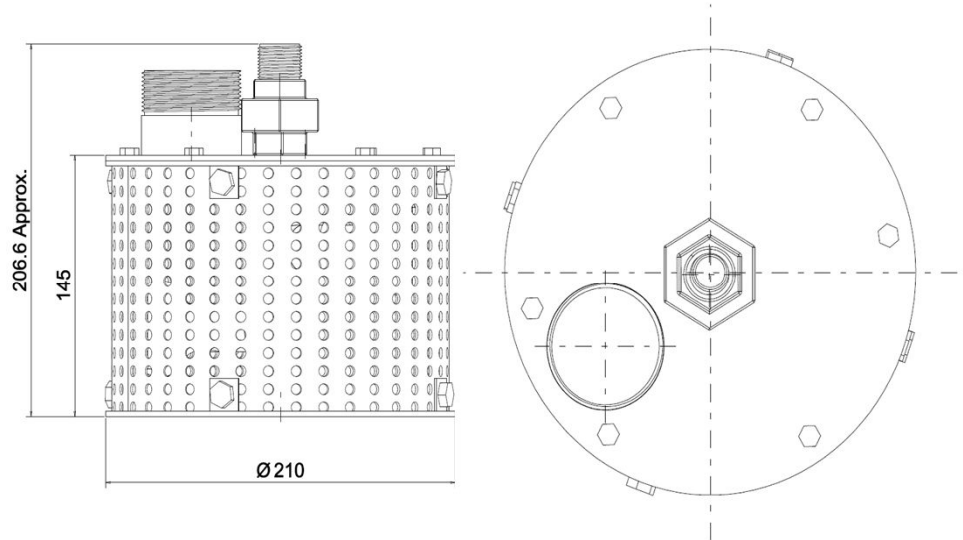

### Self-cleaning Filter Construction

Component	RF200A / RF200AS	RF200AR / RF200R
Filter cage and lid	304 Stainless Steel	
Central turbine	304 Stainless Steel	
Jets	304 Stainless Steel	Food Grade Natural Rubber
Bearings	Acetal copolymer	